

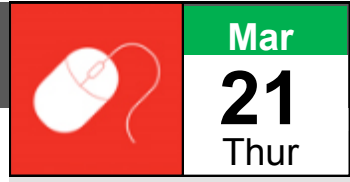

GUIDED TOUR



Arcadis Office

The Asia headquarters of Arcadis, the leading global Design & Consultancy for natural and built assets, has moved into a 78,000 sq. ft. office spread over three floors connected via internal staircases at Two Harbour Square, Kwun Tong. With the move, Arcadis Hong Kong's business lines of Cost Management, Project Management & Business Advisory, and Design & Engineering, will be housed in a single location for the first time. The office has been designed to promote greater collaboration, support sustainability, and create a strong sense of community and well-being.

The new office space is more than just a move; it is a catalyst for wider business transformation in business efficiency and how services are delivered to clients. Each floor has two large neighbourhood squares and various huddle spaces to facilitate face-to-face interaction, encourage people to share experiences, nurture creativity and work as a cohesive team. In an activity based working environment, everyone is free to choose the workplace best suits their workstyle, the type of task needed to perform, and how they will collaborate with others.

In this tour, we will be able to know more Arcadis's new workplace strategy and their move and change management.

ITINERARY:

- 4:45pm - Assembly at Lobby of Two Harbour Square, 180 Wai Yip Street, Kwun Tong
- 5:00pm - Reception and Networking
- 5:15pm - Arcadis New Workplace Strategy
- 5:00pm - Move and Change management
- 6:15pm - End of the visit

DATE : Thursday, 21 March 2019

TIME : 17:00—19:00

VENUE: L17, Two Harbour Square
180 Wai Yip Street, Kwun Tong
Kowloon, Hong Kong

CPD : 2 hours

LANGUAGE: English

ENQUIRIES :

2512 0111 / registration@ifma.org.hk

REGISTRATION FEE :

- Student Members / Young Professional Members: Free Admission
- IFMA HK Chapter Members / Corporate Partners: HK\$80
- IFMA Base Members / Supporting Organizations : HK\$150
- Non members : HK\$200

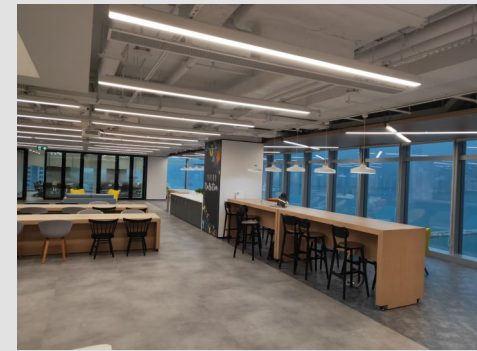
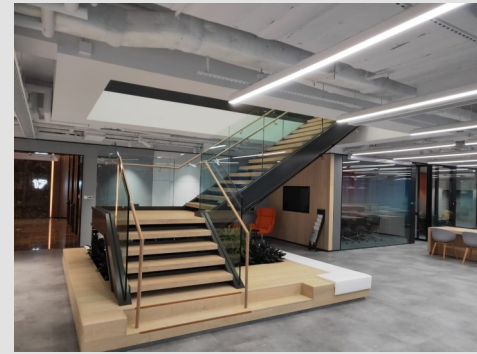

Gold Partner



Silver Partners



Supporting Organizations

